



SEQ832

**3 SECTION HYDRAULIC
LIFT COUCH**

Thank you for purchasing the SEQ832 - 3 Section Hydraulic Lift
Couch.

Please read the user manual carefully before using this product.

1. About This Manual

This manual should only be used for the reference of operation of this particular model. If the manual is used for other purposes, Salonserve will not undertake any according consequences and responsibility. All information within this manual shall be protected by copyright and shall not be copied and translated in any part of this specification without the written consent of Salonserve.

2. Warning

- Do not stand on this equipment.
- Please adjust the backrest to the highest position when not in use.
- Please contact distributor, service center or related personal with appropriate skill and experience for repairing if the plug is damaged in any way.
- This product is NOT SUITABLE FOR MASSAGE.
- Use of equipment should only be carried out by trained professionals.

3. Precautions

- This product should be used by an experienced person who must be familiar with the product structure, performance and instructions.
- Read this manual carefully before installation, operation and adjustment. Keep the manual safe for future reference.
- This product shall not be used for single side or single point loading work. This product is NOT SUITABLE FOR MASSAGE.
- Tighten bolts and nuts regularly to avoid failure caused by loose, sliding, vibration and falling off.
- During the maintenance, the operator shall not disassemble any parts of the bed.
- Do not use this product if faulty. If any abnormal sound is found, it must be stopped for inspection immediately, and work can be resumed after troubleshooting.
- The operator must be familiar with the precautions described in each section of the manual to ensure the safety of person and product.
- Please operate the product strictly in accordance with the warning label stamped on it.
- Maintenance should be carried out by trained professionals.
- After every treatment, please only use neutral solution to clear any dust or residue on the product.
- When adjusting each part, please keep your hands, feet and head away from the position indicated by the arrow. (As shown in the photo)

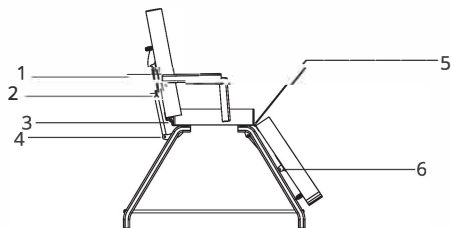

4. Installation

1. Place the equipment in a clean, dry and cool environment.
2. Open the packing carton to check if the product is intact and whether the accessories or spares are complete. Please contact distributor if there are any issues.
3. Installation

Please note that it is unnecessary to install extra screws onto the floor to fasten the bed, because stability performance has been taken into consideration.

Please ensure the product is placed on a firm and flat ground, to any avoid accident. If the product rotates or slants due to uneven ground, please adjust the four pieces of plastic feet (M10×30) and nuts (M10) by hexagon open-end wrench, which are to fasten on the bottom panel, so as to ensure the product is completely stable.

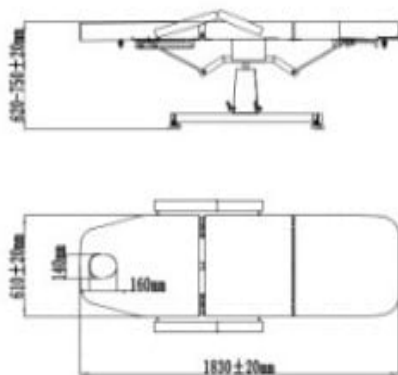

- **Steps for installing the base** install in sequence,
as shown below

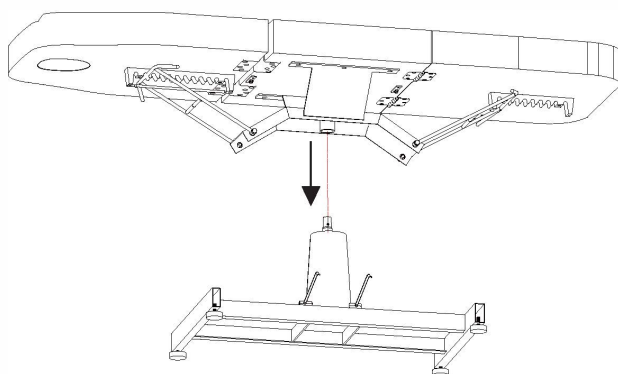
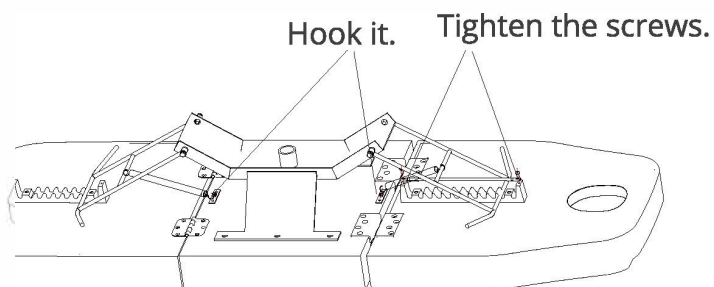

Install the armrests as below
This product graphic is for reference only.

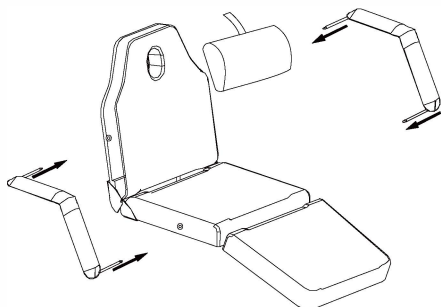

5. Technical Parameters

Max loading capacity	175kg
Package Size	189×23×66cm(2301) 189×25×66cm(2302/2304/2305/2309) 120×48×66cm(2303 TOP) 108×60×44cm(2303 BASE)
Net Weight	27kg(2301)/40kg(2302)/35kg(2304)/30kg(2305)/ 32kg(2303 TOP)/28kg(2303 BASE)
Gross Weight	31kg(2301)/43kg(2302)/38kg(2304)/33kg(2305)/ 36kg(2303 TOP)/32kg(2303 BASE)

2301 / 2305 / 2309

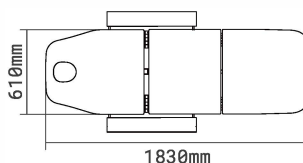
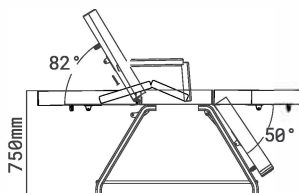

2302 / 2304

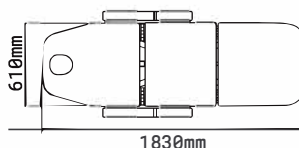
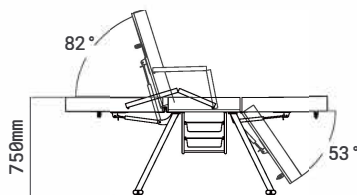

SEQ832 - YOUR MODEL

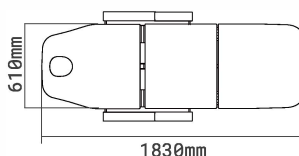
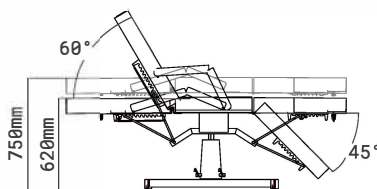

6. Maintenance

1. After every treatment, please only use neutral solution to clear any dust or stains on leather, metal part or other parts. DO NOT USE disinfecting solution like alcohol, acid or alkaline solution. This is to prevent the lifetime of the components from being shortened.
2. Please lubricate the moving parts regularly (once a year).

7. Troubleshooting

The Fault	Reason	Solution
Abnormal Sound	1. The rotating parts are short of lubricating oil.	1. Add lubricating oil.
	2. Rotating positions (such as hinge, POM sets, gas lift) are short of lubricating oil.	2. Add lubricating oil.

If problem is still not solved after above operations, please contact maintenance center or supplier.



Do not dispose of old or defective appliances in domestic waste; this should only be done through public collection points.

▲ Please check the product specification before use. This manual is for reference only. Specifications are subject to change without prior notice.